

## MWP-302/WEP-302 LA

The MWP-302 and WEP-302 can integrate with existing Line Monitoring solutions from Webb Electronics without requiring any extra hardware. There is a built-in normally open (NO) that allows direct connection to the Lobby Alert System. The Alarm Relay will be triggered upon loss of AC power or Analog/VoIP line disconnect.

*Note: The MWP-302 still supports the same expansion boards as the MWP-150. However, for the LAS Connection, the expansion board is now completely optional.*

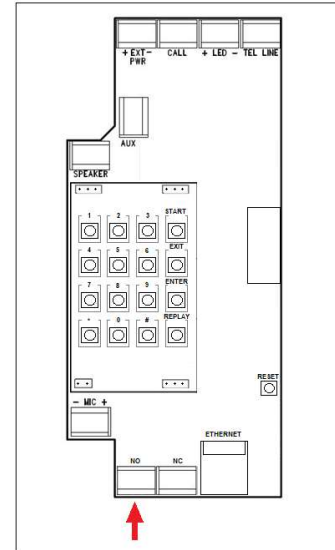

MWP-302 Normally Open (NO) Dry contact

## LINE MONITORING

### ANALOG [MWP-302]

The MWP-302 monitors the analog line constantly. Whenever the phone senses a line disconnect, it will trigger an alarm signal within 60 seconds. The alarm will be cleared automatically once the line goes back to normal.

### VoIP [WEP-302]

Upon detecting a connection failure, the WEP-302 will trigger an alarm signal within 30 seconds. Again, the alarm will be cleared as soon as the connection with the VoIP server has been reestablished.

### Note

The WEP-302 is a hybrid analog/VoIP emergency phone. It is a failsafe solution able to fall back and use the analog line (if connected) in case the phone loses connection with the VoIP server.

In this case, if there is an analog line connected, the WEP-302 will check its status before triggering the alarm relay.

## PHONE LINE MONITORING SYSTEM TYPICAL WIRING DIAGRAM

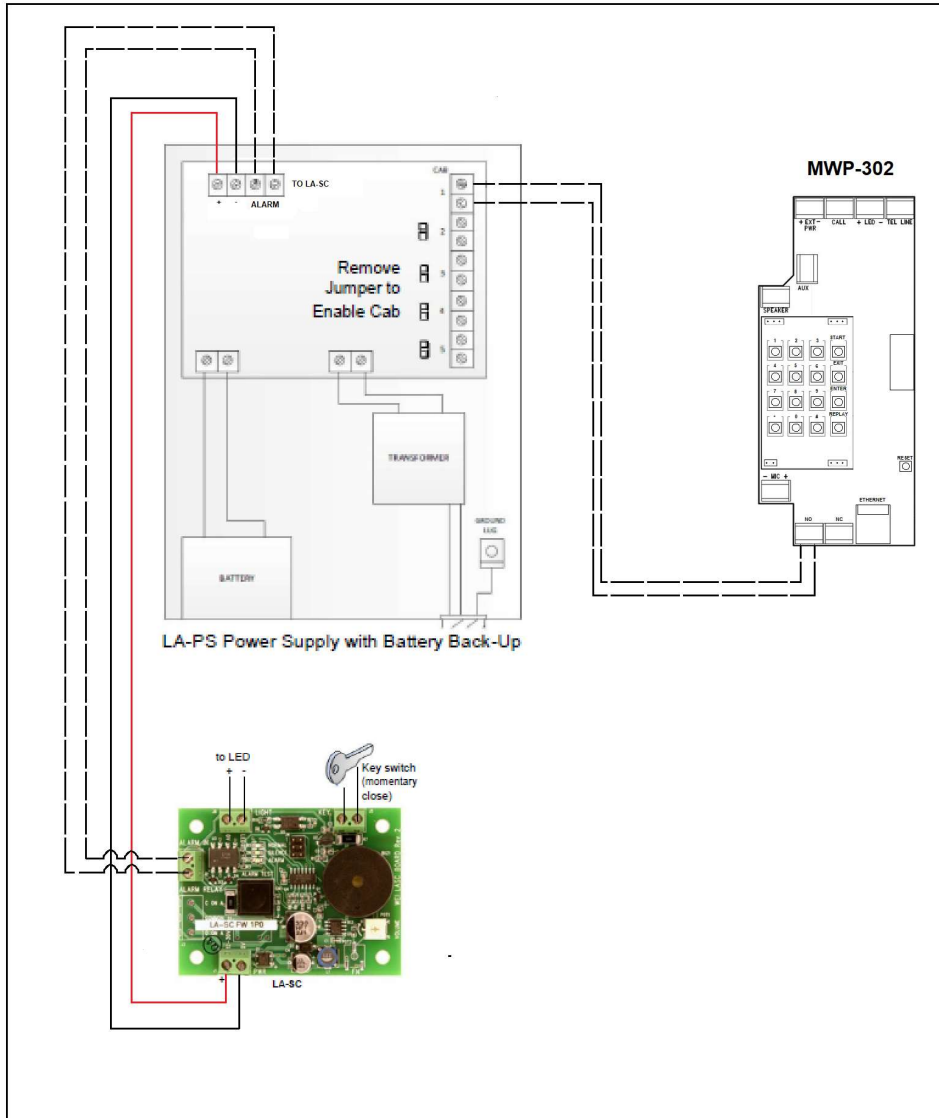

Figure 2 – MWP-302 Line monitoring wiring.

### Note

If using an analog line, make sure **function 12 is set to 6 on the MWP-302.**